

ASSESSOR'S USE ONLY  
Recertification Date:  
\_\_\_\_\_

**APPLICATION FOR  
MAINE TREE GROWTH TAX LAW PROGRAM**

36 M.R.S. §§ 571-584-A

See Property Tax Bulletin No. 19 for more information

1. Name of owner(s): Charles Tobie Trust

2. Mailing address: 48 Back Street  
Hebron, ME 04238 Phone: 966-3002

3. Location of parcel (municipality and county): Hebron, Oxford

4. Identification of parcel: R-1 11  
Tax Map Plan Lot

5. Forest land used for commercial forest production

<u>Type</u>	<u>Number of Acres</u>
a. Softwood .....	<u>10</u>
b. Mixed wood .....	<u>10</u>
c. Hardwood .....	_____
d. <b>TOTAL ACRES</b> (add lines 5a through 5c).....	5d. <u>20</u>

6. Land unsuitable for commercial forest production

<u>Type</u>	<u>Number of Acres</u>
a. Natural water and man-made water areas.....	_____
b. Wetlands (swamp, marsh) .....	<u>1</u>
c. Ledges and barrens .....	_____
d. <b>TOTAL ACRES</b> (add lines 6a through 6c).....	6d. <u>1</u>

7. Land not used primarily for commercial forest production

<u>Type</u>	<u>Number of Acres</u>
a. Building area .....	<u>3</u>
b. Fields .....	_____
c. Gravel pits .....	_____
d. Transmission line or pipeline right-of-way area .....	<u>4</u>
e. Class I roads (includes culverts, ditching, gravel) .....	_____
f. Class II roads (unimproved haul road) .....	_____
g. Agricultural area (list _____) .....	_____
h. Other areas (list _____) .....	_____
i. <b>TOTAL ACRES</b> (add lines 7a through 7h).....	7i. <u>7</u>

8. **TOTAL AREA OF PARCEL** (Add 5d, 6d and 7i) ..... 8. 28

9. Check one. A licensed forester must complete the Forester Section below.

- Initial request for classification of this parcel in the Tree Growth Tax Law program. **You must file this application on or before April 1.**
- Application for an existing classified parcel with a new forest management and harvest plan.
- Application for a new owner of an existing classified parcel adopting the previous owner's forest management and harvest plan. Date of the plan prepared for the parcel: \_\_\_\_\_.
- Recertification of the forest management and harvest plan for an existing classified parcel.
- Application submitted at the request of the assessor.

10. Are there any structures or improvements on the property?  Yes  No

11. Under penalties of perjury, I declare that I have examined this application and to the best of my knowledge and belief it is true, correct, and complete. I swear that, as owner of the property classified under the Tree Growth Tax Law, my primary use for the forest land is to grow trees to be harvested for commercial use or that the forest land is land described in 36 M.R.S. § 573(3) and that I will follow the provisions of the applicable forest management and harvest plan. I declare that all owners of the parcel agree to classification of the parcel under the Tree Growth Tax Law.

*Charles T. Kis*

*2-25-19*

Signature of Owner/Authorized Agent\*

Date

\*Multiple owners: If all owners agree to classification of the property under Tree Growth Tax Law, the owner's authorized agent may sign this form.

**FORESTER SECTION: This section is to be completed by the forester**

Name of licensed forester who approved/prepared the plan: Aaron Mason

Forester license number: LF3266 Forester telephone number: 754-8101

Date plan prepared: 2/26/19 Date plan expires: 2/26/29 Date parcel inspected: 2/22/19

The forester's signature is required if plan is adopted from prior owner or for recertification of the forest management and harvest plan. Check the appropriate box.

- For a plan adopted by a new owner following a land transfer, I hereby swear that the new owner is managing the forest land in accordance with the plan prepared for the previous landowner.
- For a plan being recertified, I hereby swear that I have inspected the parcel and that the owner is managing the parcel according to the forest management and harvest plan.

*Aaron Mason*

*2/26/19*

Signature of Licensed Forester

Date

**ASSESSOR SECTION: This section is to be completed by the assessor**  Approved  Denied

Assessor's Signature

Date

# FOREST MANAGEMENT & HARVEST PLAN UPDATE

PREPARED FOR

**Charles Tobie**

48 Back Street

Hebron, Maine 04238

Phone #966-3002

Charles Tobie Trust Property  
Property located in Hebron, Maine  
Tax Map R1 Lots 11, 11A, & 12

TOTAL ACREAGE 75 +/-

**Tax Map R-1 Lot 11**

10 acres softwood

10 acres mixed wood

1 acre wetland

4 acres Transmission Line

3 acres houselot

**Tax Map R-1 Lot 12**

10 acres softwood

26 acres mixed wood

5 acres Transmission Line

Prepared By

Aaron Mason

Jon Mason & Son Inc.

356 Greenwood Mountain Road

Hebron, Maine 04238

754-8101

License # LF3266

February 2019

# Charles Tobie Trust Property Hebron, Maine Forest Type Map

Tax Map R-1 Lot 11

Softwood	10 acres
Mixed Wood	10 acres
Wetland	1 acre
Vacant	2 acres
Transmission Line	4 acres
Building Area	1 acre
<b>Total</b>	<b>28 acres</b>

Tax Map R-1 Lot 12

Softwood	10 acres
Mixed Wood	26 acres
Transmission line	5 acres
<b>Total</b>	<b>41 acres</b>

Tax Map R-1 Lot 11A

Mixed Wood	5 acres
Building Area	1 acre
<b>Total</b>	<b>6 acres</b>

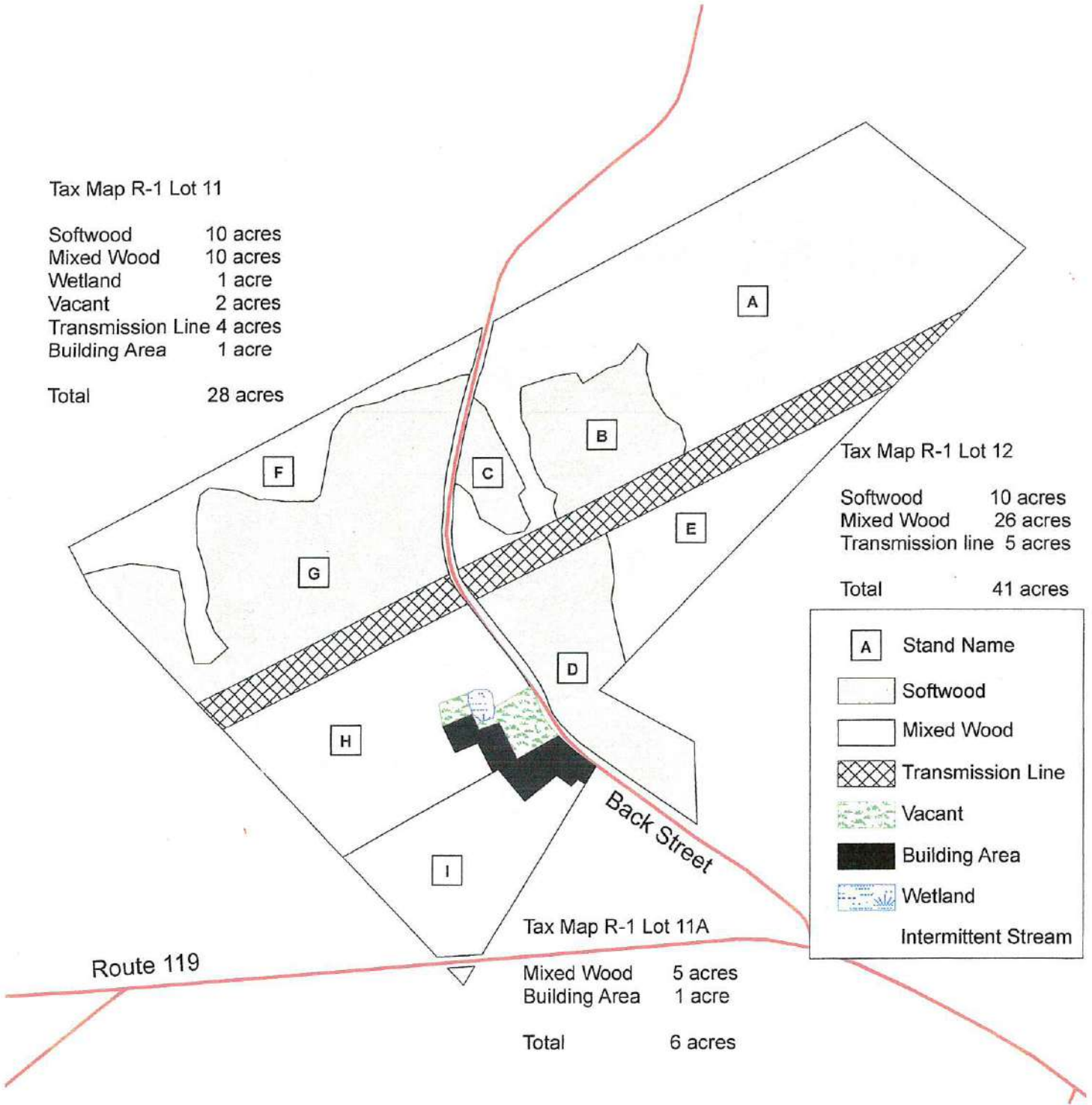

<b>A</b>	Stand Name
	Softwood
	Mixed Wood
	Transmission Line
	Vacant
	Building Area
	Wetland
	Intermittent Stream



Prepared by:  
New England Forestry Consultants, Inc  
Sherman R. Small, Consulting Forester  
Maine License # LF655  
February 27, 2009

Sketch map for management and planning purposes only, NOT A LEGAL SURVEY  
Data obtained from Maine Office of GIS & New England Forestry Consultants, Inc.